

ASSEMBLY LIST

A'		B'		C'		D'	
	4 x 25 Screw	26	Legs joints	2	Leg	6	Felt pad

MATERIAL LIST

A	
	Seat
	2

★ **A T T E N T I O N**

- Do not start assembly without being sure that all the parts are complete
- in order not to scratch the parts , place a carton or nylon series on the installation place
- To avoid damages during installation , always work with two peoples
- Keep your children away to avoid tripping and bumping

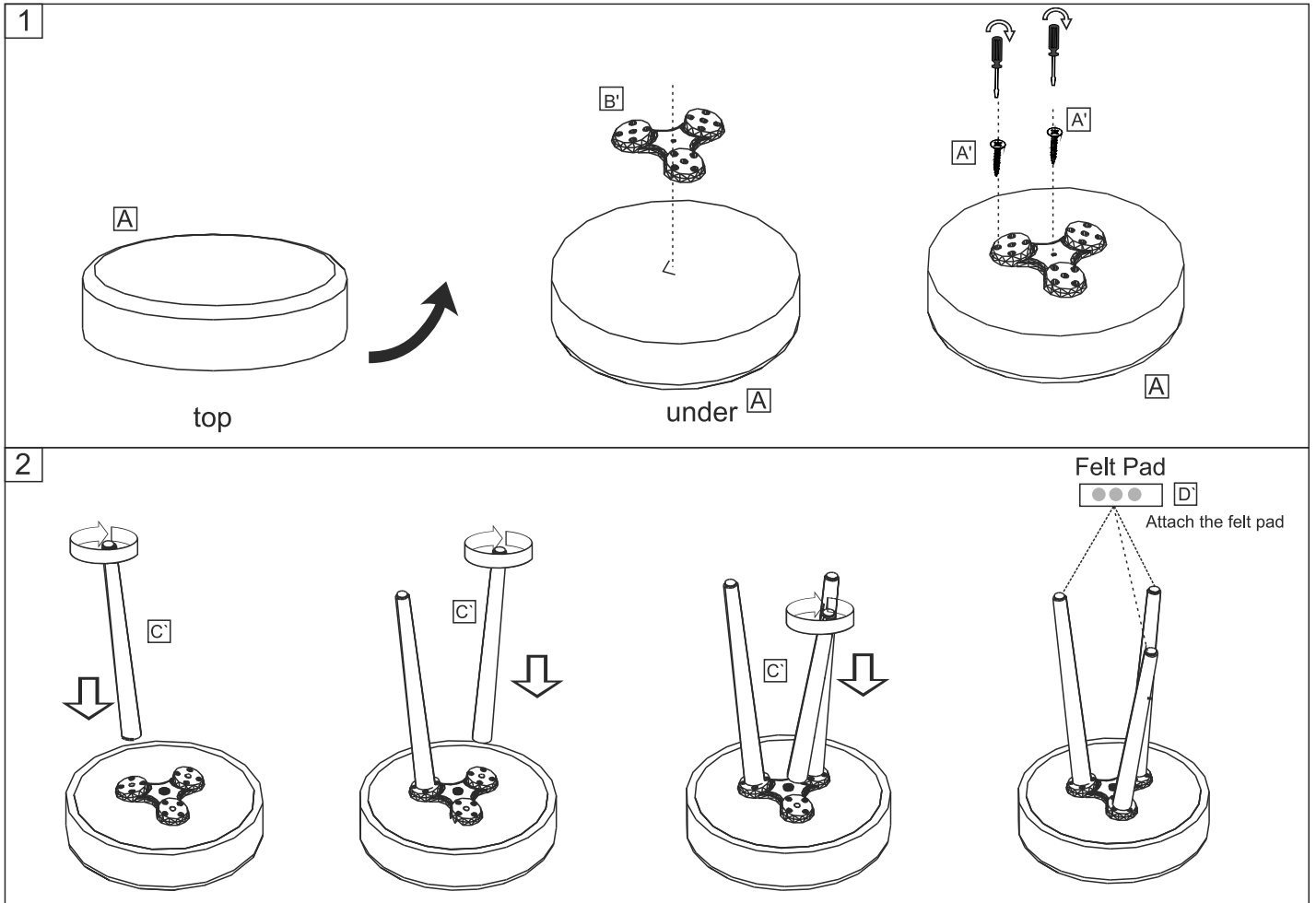

ATTENTION

For your safety, 3 feet should be contacted on the floor while seated.

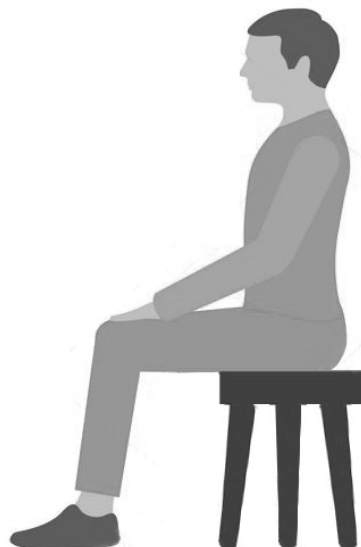

✓ Correct

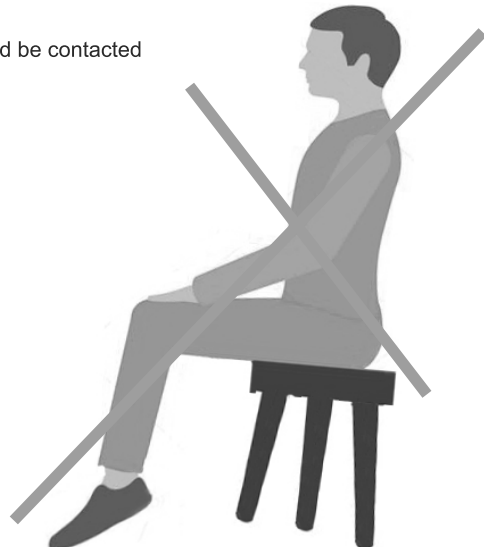

X incorrect